

# Concord

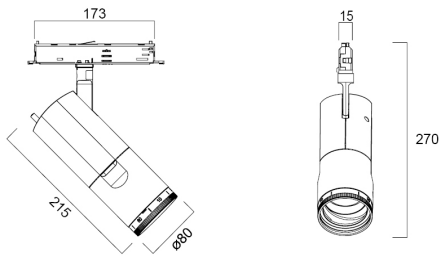

Distance [m]	Cone diameter [m]		Illuminance [lx]		
	0.05	0.06	E(0°)	E(C/90) 4°	E(C/0) 4°
0.5	0.05	0.06	30396	1723	16222
1.0	0.15	0.16	3099	427	4226
1.5	0.23	0.24	2733	194	1889
2.0	0.31	0.31	2133	1277	1251
2.5	0.38	0.39	1344	689	673
3.0	0.46	0.47	933	479	467

Distance [m]    Cone diameter [m]    Illuminance [lx]  
 — C0 - C180 (Half beam angle: 9.0°)    — C90 - C270 (Half beam angle: 9.0°)

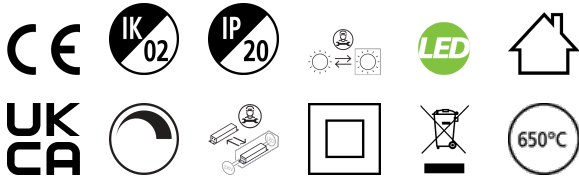