

Concord Beacon 2700k Narrow SSC White

Item No: 2062487

Concord

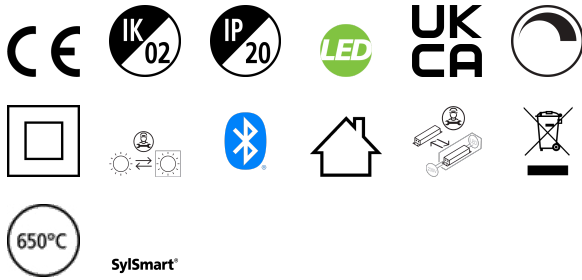

Simple and slick integral design with no driver box and without any visible screws New technology utilization for improved performance Invisible in-track adaptor for an impressive architectural look Extremely precise light beams due to the high-quality lenses ø80mm die-cast aluminium body, Fix beam angle: 19°, Textured white finishing colour Light color temperature: 2700K, candle light System power: 18W, Fixture lumen output: 1575lm, efficacy: 88lm/W, Ra97 typical, LED chromacity: 2 step MacAdam ellipse LED source (SDCM2), IR/UV free light source without heat radiation Operating voltage 220-240V / 50-60Hz, electronic driver, dimmable via SylSmart Standalone SSC Suitable for installation on 3-circuit tracks, please check compatibility list on the instruction sheet. Compatible with OneTrack Electrical protection: Class II. Degree of protection: IP20, suitable for indoor environment only Horizontal rotation: 355°, vertical tilt: 90° Nominal product dimensions: D.80mmx200mm 5 years warranty. Suitable for track mounting

Technical Assets

Dimensions (mm)

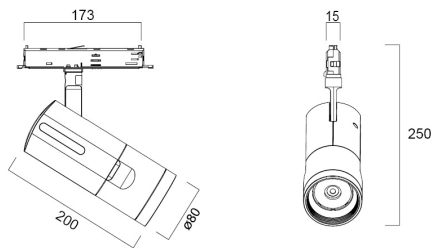

Photometrics

| Distance [m] | Cone diameter [m] | Beam diameter [m] | Beam diameter [m] | Illuminance [lx] |
|--------------|-------------------|-------------------|-------------------|----------------------|
| 0.5 | 0.17 0.17 | 0.07 | 0.07 | 3487 1810 1810 |
| 1.0 | 0.35 0.34 | 0.14 | 0.14 | 874 428 428 |
| 1.5 | 0.52 0.51 | 0.21 | 0.21 | 387 186 186 |
| 2.0 | 0.69 0.68 | 0.28 | 0.28 | 217 131 131 |
| 2.5 | 0.86 0.85 | 0.35 | 0.35 | 139 83 83 |
| 3.0 | 1.04 1.03 | 0.42 | 0.42 | 87 47 47 |

Distance [m] Cone diameter [m] Beam diameter [m] Illuminance [lx]
 — C0 - C180 (Half beam angle: 19.4°)
 — C90 - C270 (Half beam angle: 19.4°)

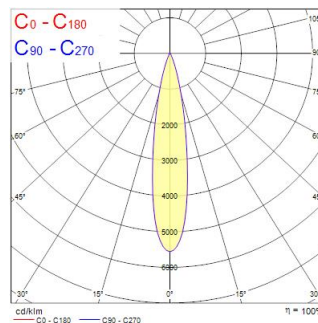

Concord Beacon 2700k Narrow SSC White

Item No: 2062487

Concord

General data

| | |
|----------------------------------|--|
| Product name | Concord Beacon 2700k Narrow SSC White |
| Technology | LED |
| Cap/Base | N/A |
| Housing | Aluminium |
| Mount | Track mounting |
| Built in presence detector | NONE |
| Fixture rating | Enclosed |
| General application | Museums & Galleries, Retail, Hospitality |
| Operating temperature range (°C) | -10°C...+35°C |
| Virtual assistant compatibility | N/A |
| ETIM Class | EC001744 |
| Warranty | 5 years |

Optical data

| | |
|-----------------------------------|-------------|
| Fixture luminous flux (lm) | 1575 |
| Luminaire efficacy (lm/W) | 88 |
| LOR (%) | 100 |
| Correlated colour temperature (k) | 2700 |
| Light colour | Candlelight |
| CRI (Ra) | 97 |
| Colour Variation Initial (SDCM) | SDCM2 |
| Luminous Intensity (cd) | 1575 |
| Beam Angle (°) | 19 |
| Distribution type | Symmetric |
| Photobiological Risk Group | RG1 |

Electrical data

| | |
|--|-----------------------------|
| Emergency type | |
| Total power consumption (W) | 18 |
| Supply current (A) | 0.082 |
| Primary Supply/Product voltage - min (V) | 220.0 |
| Primary Supply/Product voltage - max (V) | 240.0 |
| Lamp power factor | 0.9 |
| THD (at 230 V, 50 Hz, full load, at 100% dimming level) ≤ xx.x % | 8.2 |
| Electrical protection | Class II |
| Control gear type | LED driver constant current |
| Dimmable | Yes |
| Dimming method | SylSmart Standalone (SSC) |
| Minimum dimming level (%) | 1 |
| Drive current (mA) | 500 |
| Inrush Current (A) | 20 |
| Inrush Duration (µs) | 25 |
| Energy Efficiency Class (A->G) of contained light source | F |
| Nominal Frequency (Hz) | 50/60Hz |
| Max. products per 10A C Breaker | 50 |
| Max. products per 13A C Breaker | 104 |
| Max. products per 16A C Breaker | 136 |
| Max. products per 20A C Breaker | 166 |
| Max. products per 10A B Breaker | 50 |
| Max. products per 13A B Breaker | 62 |
| Max. products per 16A B Breaker | 80 |
| Max. products per 20A B Breaker | 100 |

Lifetime data

| | |
|------------------|--------|
| Lifespan L70 B50 | 100000 |
| Lifespan L80 B50 | 100000 |
| Lifespan L90 B50 | 56000 |

Concord Beacon 2700k Narrow SSC White

Item No: 2062487

Concord

Physical data

| | |
|-----------------------------|----------------------------------|
| Housing colour | RAL 9016 - Traffic white / Bezel |
| IP rating | IP20 |
| IK rating | IK02 |
| Diffuser finish | Other |
| Diffuser material | PMMA Acrylic |
| Reflector finish | Not Applicable |
| Nominal Product Length (mm) | 200 |
| Nominal Product Width (mm) | 80 |
| Nominal Product Height (mm) | 250 |
| Weight (kg) | 1.2 |

Packaging

| | |
|---------------------------------------|----------------|
| Product EAN number | 5025768624874 |
| Packaging single length / height (cm) | 30.5 |
| Packaging single width (cm) | 13.5 |
| Packaging single depth (cm) | 20.5 |
| DUN14 (inner) | 05025768624874 |
| Units per outer package | 1 |
| Packaging outer length / height (cm) | 30.5 |
| Packaging outer width (cm) | 13.5 |
| Packaging outer depth (cm) | 20.5 |

Safety data

| | |
|----------------------------------|--------|
| Glow Wire Test (°C) | 650 |
| Optimal operating condition (°C) | -10-35 |
| Dry applications use only | Yes |