

Concord Beacon 3000k Narrow SSC Black

Item No: 2062497

Concord

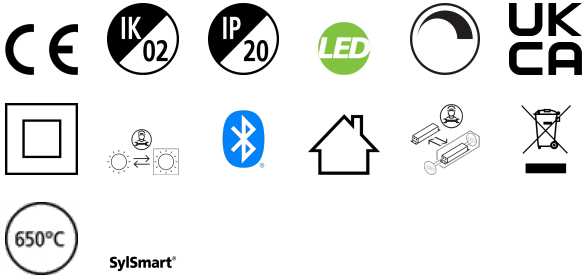

Simple and slick integral design with no driver box and without any visible screws New technology utilization for improved performance Invisible in-track adaptor for an impressive architectural look Extremely precise light beams due to the high-quality lenses ø80mm die-cast aluminium body, Fix beam angle: 19°, Textured black finishing colour Light color temperature: 3000K, warm light System power: 18W, Fixture lumen output: 1850lm, efficacy: 103lm/W, Ra97 typical, LED chromacity: 2 step MacAdam ellipse LED source (SDCM2), IR/UV free light source without heat radiation Operating voltage 220-240V / 50-60Hz, electronic driver, dimmable via SylSmart Standalone SSC Suitable for installation on 3-circuit tracks, please check compatibility list on the instruction sheet. Compatible with OneTrack Electrical protection: Class II. Degree of protection: IP20, suitable for indoor environment only Horizontal rotation: 355°, vertical tilt: 90° Nominal product dimensions: D.80mmx200mm 5 years warranty. Suitable for track mounting

Technical Assets

Dimensions (mm)

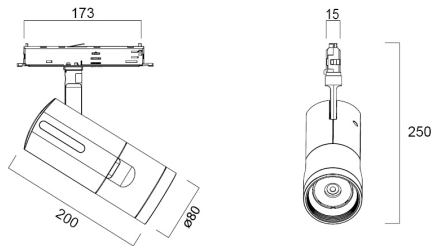

Photometrics

Distance [m]	Cone diameter [m]	Beam diameter [m]	Illuminance [lx]
0.5	0.17 0.17	0.07 0.07	4248 2071 2152
1.0	0.34 0.33	0.14 0.14	1062 523 535
1.5	0.51 0.50	0.21 0.21	457 230 236
2.0	0.68 0.67	0.28 0.28	276 131 133
2.5	0.85 0.84	0.35 0.35	178 89 90
3.0	1.01 1.00	0.42 0.42	127 63 64

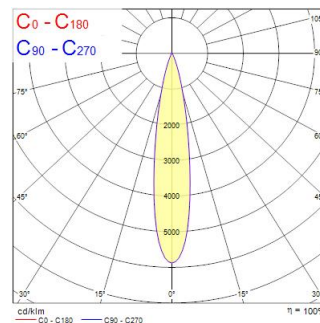

Concord Beacon 3000k Narrow SSC Black

Item No: 2062497

Concord

General data

Product name	Concord Beacon 3000k Narrow SSC Black
Technology	LED
Cap/Base	N/A
Housing	Aluminium
Mount	Track mounting
Built in presence detector	NONE
Fixture rating	Enclosed
General application	Museums & Galleries, Retail, Hospitality
Operating temperature range (°C)	-10°C...+35°C
Virtual assistant compatibility	N/A
ETIM Class	EC001744
Warranty	5 years

Optical data

Fixture luminous flux (lm)	1850
Luminaire efficacy (lm/W)	103
LOR (%)	100
Correlated colour temperature (k)	3000
Light colour	Warm White
CRI (Ra)	97
Colour Variation Initial (SDCM)	SDCM2
Luminous Intensity (cd)	1850
Beam Angle (°)	19
Distribution type	Symmetric
Photobiological Risk Group	RG1

Electrical data

Emergency type	
Total power consumption (W)	18
Supply current (A)	0.082
Primary Supply/Product voltage - min (V)	220.0
Primary Supply/Product voltage - max (V)	240.0
Lamp power factor	0.9
THD (at 230 V, 50 Hz, full load, at 100% dimming level) ≤ xx.x %	8.2
Electrical protection	Class II
Control gear type	LED driver constant current
Dimmable	Yes
Dimming method	SylSmart Standalone (SSC)
Minimum dimming level (%)	1
Drive current (mA)	500
Inrush Current (A)	20
Inrush Duration (µs)	25
Energy Efficiency Class (A->G) of contained light source	F
Nominal Frequency (Hz)	50/60Hz
Max. products per 10A C Breaker	50
Max. products per 13A C Breaker	104
Max. products per 16A C Breaker	136
Max. products per 20A C Breaker	166
Max. products per 10A B Breaker	50
Max. products per 13A B Breaker	62
Max. products per 16A B Breaker	80
Max. products per 20A B Breaker	100

Lifetime data

Lifespan L70 B50	100000
Lifespan L80 B50	100000
Lifespan L90 B50	56000

Concord Beacon 3000k Narrow SSC Black

Item No: 2062497

Concord

Physical data

Housing colour	RAL 9005 - Jet black
IP rating	IP20
IK rating	IK02
Diffuser finish	Other
Diffuser material	PMMA Acrylic
Reflector finish	Not Applicable
Nominal Product Length (mm)	200
Nominal Product Width (mm)	80
Nominal Product Height (mm)	250
Weight (kg)	1.2

Packaging

Product EAN number	5025768624973
Packaging single length / height (cm)	30.5
Packaging single width (cm)	13.5
Packaging single depth (cm)	20.5
DUN14 (inner)	05025768624973
Units per outer package	1
Packaging outer length / height (cm)	30.5
Packaging outer width (cm)	13.5
Packaging outer depth (cm)	20.5

Safety data

Glow Wire Test (°C)	650
Optimal operating condition (°C)	-10-35
Dry applications use only	Yes