

Concord Beacon 2700k Medium SSC White

Code article 2062490

Concord



Simple and slick integral design with no driver box and without any visible screws New technology utilization for improved performance Invisible in-track adaptor for an impressive architectural look Extremely precise light beams due to the high-quality lenses ø80mm die-cast aluminium body, Fix beam angle: 36°, Textured white finishing colour Light color temperature: 2700K, candle light System power: 18W, Fixture lumen output: 1325lm, efficacy: 74lm/W, Ra97 typical, LED chromacity: 2 step MacAdam ellipse LED source (SDCM2), IR/UV free light source without heat radiation Operating voltage 220-240V / 50-60Hz, electronic driver, dimmable via SylSmart Standalone SSC Suitable for installation on 3-circuit tracks, please check compatibility list on the instruction sheet. Compatible with OneTrack Electrical protection: Class II. Degree of protection: IP20, suitable for indoor environment only Horizontal rotation: 355°, vertical tilt: 90° Nominal product dimensions: D.80mmx200mm 5 years warranty. Suitable for track mounting

Atouts techniques

Dimensions (mm)

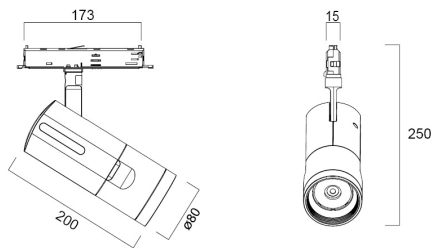

Photométrie

Distance [m]	Cone diameter [m]	Beam diameter [m]	Illuminance [lx]
0.5	0.32	Ø173	10099
		Ø120	9647
1.0	0.64	Ø173	2525
		Ø120	1412
1.5	0.96	Ø173	1421
		Ø120	657
2.0	1.28	Ø173	816
		Ø120	380
2.5	1.60	Ø173	522
		Ø120	238
3.0	1.91	Ø173	363
		Ø120	167

Distance [m] Cone diameter [m] Illuminance [lx]
 — C0 - C180 (Half beam angle: 36.4°)

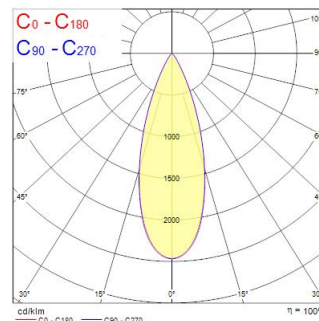

Concord Beacon 2700k Medium SSC White

Code article 2062490

Concord

Données générales

Nom du produit	Concord Beacon 2700k Medium SSC White
Technologie	LED
Cap/Base	N/A
Housing	Aluminium
Montage	Track mounting
Built in presence detector	NONE
Fixture rating	Enclosed
General application	Museums & Galleries, Retail, Hospitality
Operating temperature range (°C)	-10°C...+35°C
Virtual assistant compatibility	N/A
ETIM Class	EC001744
Warranty	5 ans

Données optiques

Fixture luminous flux (lm)	1325
Luminaire efficacy (lm/W)	74
LOR (%)	100
Température de couleur (K)	2700
Couleur de lumière	Candlelight
IRC (Ra)	97
Colour Variation Initial (SDCM)	SDCM2
Luminous Intensity (cd)	1325
Beam Angle (°)	36
Distribution type	Symmetric
Photobiological Risk Group	RG1

Caractéristiques électriques

Emergency type	
Consommation électrique totale (W)	18
Actuel (A)	0.082
Primary Supply/Product voltage - min (V)	220.0
Primary Supply/Product voltage - max (V)	240.0
Lamp power factor	0.9
THD (at 230 V, 50 Hz, full load, at 100% dimming level) ≤ xx.x %	8.2
Electrical protection	Class II
Type d'appareillage	LED driver constant current
Dimmable	Yes
Dimming method	SylSmart Standalone (SSC)
Minimum dimming level (%)	1
Drive current (mA)	500
Courant d'appel (A)	20
Inrush Duration (µs)	25
Energy Efficiency Class (A->G) of contained light source	F
Nominal Frequency (Hz)	50/60Hz
Max. products per 10A C Breaker	50
Max. products per 13A C Breaker	104
Max. products per 16A C Breaker	136
Max. products per 20A C Breaker	166
Max. products per 10A B Breaker	50
Max. products per 13A B Breaker	62
Max. products per 16A B Breaker	80
Max. products per 20A B Breaker	100

Durée de vie

Lifespan L70 B50	100000
Lifespan L80 B50	100000
Lifespan L90 B50	56000

Concord Beacon 2700k Medium SSC White

Code article 2062490

Concord

Données physiques

Housing colour	RAL 9016 - Traffic white / Bezel
IP rating	IP20
IK rating	IK02
Diffuser finish	Other
Diffuser material	PMMA Acrylic
Finition réflecteur	Not Applicable
Longueur (mm)	200
Largeur (mm)	80
Nominal Product Height (mm)	250
Poids (kg)	1.2

Emballage

Product EAN number	5025768624904
Longueur simple de l'emballage (cm)	30.5
Largeur simple de l'emballage (cm)	13.5
Packaging single depth (cm)	20.5
DUN14 (inner)	05025768624904
Units per outer package	1
Packaging outer length / height (cm)	30.5
Packaging outer width (cm)	13.5
Packaging outer depth (cm)	20.5

Sécurité

Glow Wire Test (°C)	650
Condition de fonctionnement optimal (° C)	-10-35
Utilisation pour applications sèches uniquement	Yes