

# Concord Beacon Muse 2700k O/B Dim Black

Code article 2062562

Concord

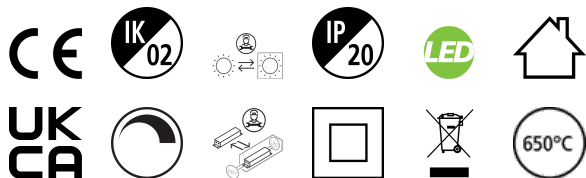

Simple and slick integral design with no driver box and without any visible screws New technology utilization for improved performance Invisible in-track Adaptor for an impressive architectural look Extremely precise light beams due to the high-quality lens  $\varnothing 80\text{mm}$  die-cast aluminium body, Adjustable beam angle: between  $8^\circ - 55^\circ$ , Textured black finishing colour Light color temperature: 2700K, candle light System power: 18W, Fixture lumen output: 940lm, efficacy: 52lm/W, Ra97 typical, LED chromacity: 2 step MacAdam ellipse LED source (SDCM2), IR/UV free light source without heat radiation Operating voltage 220-240V / 50-60Hz, dimmable via on-board potentiometer, suitable for installation on 3-circuit tracks, please check compatibility list on the instruction sheet. Compatible with OneTrack Electrical protection: Class II. Degree of protection: IP20, suitable for indoor environment only Horizontal rotation:  $355^\circ$ , vertical tilt:  $90^\circ$  Nominal product dimensions: D.80mmx215mm 5 years warranty. Suitable for track mounting

## Atouts techniques

### Dimensions (mm)

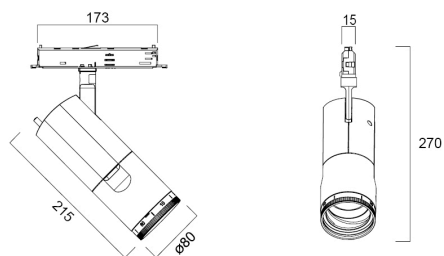

### Photométrie

Distance [m]	Cone diameter [m]	Beam diameter [m]	Beam diameter [m]	Beam diameter [m]	Illuminance [lx]
0.5	0.08 0.08	0.07 0.07	0.07 0.07	0.07 0.07	3682 1726 1033
1.0	0.15 0.15	0.14 0.14	0.14 0.14	0.14 0.14	895 438 262
1.5	0.22 0.22	0.21 0.21	0.21 0.21	0.21 0.21	399 198 121
2.0	0.31 0.30	0.30 0.30	0.30 0.30	0.30 0.30	227 113 68
2.5	0.38 0.38	0.37 0.37	0.37 0.37	0.37 0.37	142 71 43
3.0	0.46 0.45	0.45 0.45	0.45 0.45	0.45 0.45	96 48 29

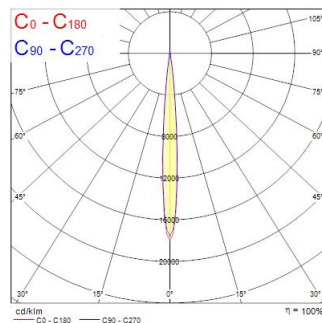

# Concord Beacon Muse 2700k O/B Dim Black

Code article 2062562

# Concord

## Données générales

Nom du produit	Concord Beacon Muse 2700k O/B Dim Black
Technologie	LED
Cap/Base	N/A
Housing	Aluminium
Montage	Track mounting
Built in presence detector	NONE
Fixture rating	Enclosed
General application	Museums & Galleries, Retail, Hospitality
Operating temperature range (°C)	-10°C...+35°C
Virtual assistant compatibility	N/A
ETIM Class	EC001744
Numéro virtuel FI	4170388
Warranty	5 ans

## Données optiques

Fixture luminous flux (lm)	940
Luminaire efficacy (lm/W)	52
LOR (%)	100
Température de couleur (K)	2700
Couleur de lumière	Candlelight
IRC (Ra)	97
Colour Variation Initial (SDCM)	SDCM2
Luminous Intensity (cd)	940
Distribution type	Symmetric
Photobiological Risk Group	RG1

## Caractéristiques électriques

Emergency type	
Consommation électrique totale (W)	18
Actuel (A)	0.082
Primary Supply/Product voltage - min (V)	220.0
Primary Supply/Product voltage - max (V)	240.0
Lamp power factor	0.9
THD (at 230 V, 50 Hz, full load, at 100% dimming level) ≤ xx.x %	7.9
Electrical protection	Class II
Type d'appareillage	LED driver constant current
Dimmable	Yes
Dimming method	Onboard pot
Minimum dimming level (%)	1
Drive current (mA)	500
Courant d'appel (A)	5
Inrush Duration (µs)	50
Energy Efficiency Class (A->G) of contained light source	F
Nominal Frequency (Hz)	50/60Hz
Max. products per 10A C Breaker	31
Max. products per 13A C Breaker	65
Max. products per 16A C Breaker	85
Max. products per 20A C Breaker	104
Max. products per 10A B Breaker	31
Max. products per 13A B Breaker	39
Max. products per 16A B Breaker	50
Max. products per 20A B Breaker	62

## Durée de vie

Lifespan L70 B50	100000
Lifespan L80 B50	100000
Lifespan L90 B50	49000

# Concord Beacon Muse 2700k O/B Dim Black

Code article 2062562

**Concord**

## Données physiques

Housing colour	RAL 9005 - Jet black
IP rating	IP20
IK rating	IK02
Diffuser finish	Frosted
Diffuser material	Other
Finition réflecteur	Matt
Longueur (mm)	215
Largeur (mm)	80
Nominal Product Height (mm)	270
Poids (kg)	0.94

## Emballage

Product EAN number	5025768625628
Longueur simple de l'emballage (cm)	30.5
Largeur simple de l'emballage (cm)	13.5
Packaging single depth (cm)	20.5
DUN14 (inner)	05025768625628
Units per outer package	1
Packaging outer length / height (cm)	30.5
Packaging outer width (cm)	13.5
Packaging outer depth (cm)	20.5

## Sécurité

Glow Wire Test (°C)	650
Condition de fonctionnement optimal (° C)	-10-35
Utilisation pour applications sèches uniquement	Yes