

Concord Beacon Muse 3000k O/B Dim Black

Code article 2062563

Concord



Simple and slick integral design with no driver box and without any visible screws New technology utilization for improved performance Invisible in-track Adaptor for an impressive architectural look Extremely precise light beams due to the high-quality lens $\varnothing 80\text{mm}$ die-cast aluminium body, Adjustable beam angle: between $8^\circ - 55^\circ$, Textured black finishing colour Light color temperature: 3000K, warm light System power: 18W, Fixture lumen output: 980lm, efficacy: 55lm/W, Ra97 typical, LED chromacity: 2 step MacAdam ellipse LED source (SDCM2), IR/UV free light source without heat radiation Operating voltage 220-240V / 50-60Hz, dimmable via on-board potentiometer, suitable for installation on 3-circuit tracks, please check compatibility list on the instruction sheet. Compatible with OneTrack Electrical protection: Class II. Degree of protection: IP20, suitable for indoor environment only Horizontal rotation: 355° , vertical tilt: 90° Nominal product dimensions: D.80mmx215mm 5 years warranty. Suitable for track mounting

Atouts techniques

Dimensions (mm)

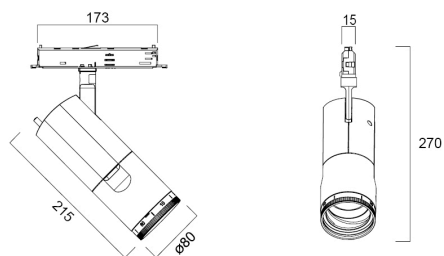

Photométrie

| Distance [m] | Cone diameter [m] | Beam diameter [m] | Beam diameter [m] | Illuminance [lx] |
|--------------|-------------------|-------------------|-------------------|----------------------|
| 0.5 | 0.08 0.08 | 0.07 | 0.07 | 3936 1723 1652 |
| 1.0 | 0.15 0.16 | 0.07 | 0.07 | 836 426 406 |
| 1.5 | 0.22 0.24 | 0.07 | 0.07 | 373 194 189 |
| 2.0 | 0.31 0.31 | 0.07 | 0.07 | 210 107 101 |
| 2.5 | 0.38 0.39 | 0.07 | 0.07 | 144 69 67 |
| 3.0 | 0.46 0.47 | 0.07 | 0.07 | 93 49 47 |

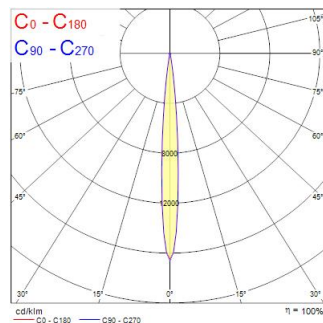

Concord Beacon Muse 3000k O/B Dim Black

Code article 2062563

Concord

Données générales

| | |
|----------------------------------|--|
| Nom du produit | Concord Beacon Muse 3000k O/B Dim Black |
| Technologie | LED |
| Cap/Base | N/A |
| Housing | Aluminium |
| Montage | Track mounting |
| Built in presence detector | NONE |
| Fixture rating | Enclosed |
| General application | Museums & Galleries, Retail, Hospitality |
| Operating temperature range (°C) | -10°C...+35°C |
| Virtual assistant compatibility | N/A |
| ETIM Class | EC001744 |
| Numéro virtuel FI | 4170389 |
| Warranty | 5 ans |

Données optiques

| | |
|---------------------------------|------------|
| Fixture luminous flux (lm) | 980 |
| Luminaire efficacy (lm/W) | 55 |
| LOR (%) | 100 |
| Température de couleur (K) | 3000 |
| Couleur de lumière | Warm White |
| IRC (Ra) | 97 |
| Colour Variation Initial (SDCM) | SDCM2 |
| Luminous Intensity (cd) | 980 |
| Distribution type | Symmetric |
| Photobiological Risk Group | RG1 |

Caractéristiques électriques

| | |
|--|-----------------------------|
| Emergency type | |
| Consommation électrique totale (W) | 18 |
| Actuel (A) | 0.082 |
| Primary Supply/Product voltage - min (V) | 220.0 |
| Primary Supply/Product voltage - max (V) | 240.0 |
| Lamp power factor | 0.9 |
| THD (at 230 V, 50 Hz, full load, at 100% dimming level) ≤ xx.x % | 7.9 |
| Electrical protection | Class II |
| Type d'appareillage | LED driver constant current |
| Dimmable | Yes |
| Dimming method | Onboard pot |
| Minimum dimming level (%) | 1 |
| Drive current (mA) | 500 |
| Courant d'appel (A) | 5 |
| Inrush Duration (µs) | 50 |
| Energy Efficiency Class (A->G) of contained light source | F |
| Nominal Frequency (Hz) | 50/60Hz |
| Max. products per 10A C Breaker | 31 |
| Max. products per 13A C Breaker | 65 |
| Max. products per 16A C Breaker | 85 |
| Max. products per 20A C Breaker | 104 |
| Max. products per 10A B Breaker | 31 |
| Max. products per 13A B Breaker | 39 |
| Max. products per 16A B Breaker | 50 |
| Max. products per 20A B Breaker | 62 |

Durée de vie

| | |
|------------------|--------|
| Lifespan L70 B50 | 100000 |
| Lifespan L80 B50 | 100000 |
| Lifespan L90 B50 | 49000 |

Concord Beacon Muse 3000k O/B Dim Black

Code article 2062563

Concord

Données physiques

| | |
|-----------------------------|----------------------|
| Housing colour | RAL 9005 - Jet black |
| IP rating | IP20 |
| IK rating | IK02 |
| Diffuser finish | Frosted |
| Diffuser material | Other |
| Finition réflecteur | Matt |
| Longueur (mm) | 215 |
| Largeur (mm) | 80 |
| Nominal Product Height (mm) | 270 |
| Poids (kg) | 0.94 |

Emballage

| | |
|--------------------------------------|----------------|
| Product EAN number | 5025768625635 |
| Longueur simple de l'emballage (cm) | 30.5 |
| Largeur simple de l'emballage (cm) | 13.5 |
| Packaging single depth (cm) | 20.5 |
| DUN14 (inner) | 05025768625635 |
| Units per outer package | 1 |
| Packaging outer length / height (cm) | 30.5 |
| Packaging outer width (cm) | 13.5 |
| Packaging outer depth (cm) | 20.5 |

Sécurité

| | |
|---|--------|
| Glow Wire Test (°C) | 650 |
| Condition de fonctionnement optimal (° C) | -10-35 |
| Utilisation pour applications sèches uniquement | Yes |