

OptiClip 600 3000K C8 HO WH DALI WHITE

Cikkszám 0043005

SYLVANIA

PROTM

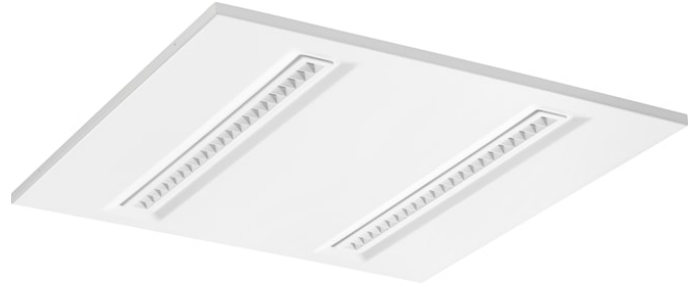
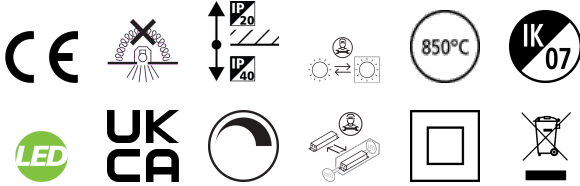

OPTICLIP 600 3000K C8 HO WH DALI WHITE is a high efficacy low glare luminaire with replaceable light engines for office and education applications. Ceiling recessed LED luminaire with white colour plastic optic, direct light distribution, luminaire dimensions: 595x595x20mm, Sylvania White body colour (RAL9016), IP40 (from the front), IK07, DALI Dimmable, low LED flicker (+/-5%), Warm White (3000K) LED Colour Temperature, 3925lm luminous flux, 33W power consumption, 119lm/W system efficacy, CRI>80, SDCM 3 (3-step MacAdam ellipse) LED Colour Consistency, UGR<17, Luminance at 65° < 2000 cd/m2, lifespan: 62,000 hours L80B20, photobiological safety risk group 1. Electrical protection Class II. Glow wire test 850°C.

Műszaki eszközök

Méretek (mm)

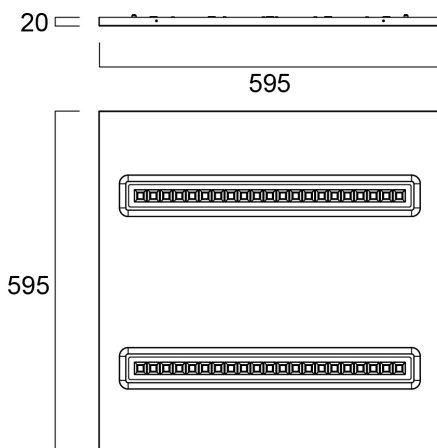

Fotometriák

Distance [m]	Cone diameter [m]	Beam angle [°]	Beam diameter [m]	Beam diameter [ft]	Illuminance [lx]
0.5	0.81 0.83	30°	0.81	2.66	9431
		35°	0.83	2.72	2202
		38°	0.86	2.80	1542
1.0	1.61 1.67	30°	1.61	5.28	2385
		35°	1.67	5.48	885
		38°	1.74	5.71	591
1.5	2.42 2.50	30°	2.42	7.95	1048
		35°	2.50	8.20	388
		38°	2.59	8.51	268
2.0	3.23 3.33	30°	3.23	10.60	588
		35°	3.33	10.93	210
		38°	3.44	11.28	154
2.5	4.03 4.17	30°	4.03	13.22	377
		35°	4.17	13.68	138
		38°	4.32	14.17	98
3.0	4.84 5.00	30°	4.84	15.88	262
		35°	5.00	16.40	92
		38°	5.17	16.96	68

Distance [m] Cone diameter [m] Illuminance [lx]
 — C0 - C180 (Half beam angle: 78.9°)
 — C90 - C270 (Half beam angle: 77.8°)

