

# Beacon CRI97 18W 1850lm 3000K Smal SSC Wit

Artikelnummer 2062488

Concord

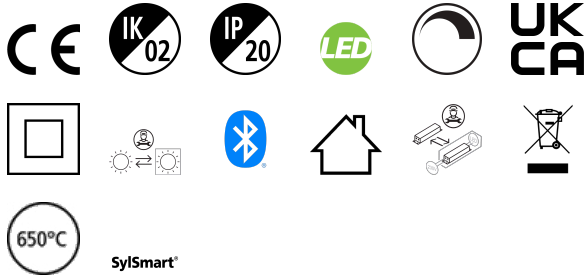

Simple and slick integral design with no driver box and without any visible screws New technology utilization for improved performance Invisible in-track adaptor for an impressive architectural look Extremely precise light beams due to the high-quality lenses ø80mm die-cast aluminium body, Fix beam angle: 19°, Textured white finishing colour Light color temperature: 3000K, warm light System power: 18W, Fixture lumen output: 1850lm, efficacy: 103lm/W, Ra97 typical, LED chromacity: 2 step MacAdam ellipse LED source (SDCM2), IR/UV free light source without heat radiation Operating voltage 220-240V / 50-60Hz, electronic driver, dimmable via SylSmart Standalone SSC Suitable for installation on 3-circuit tracks, please check compatibility list on the instruction sheet. Compatible with OneTrack Electrical protection: Class II. Degree of protection: IP20, suitable for indoor environment only Horizontal rotation: 355°, vertical tilt: 90° Nominal product dimensions: D.80mmx200mm 5 years warranty. Suitable for track mounting

## Technische gegevens

### Afmetingen (mm)

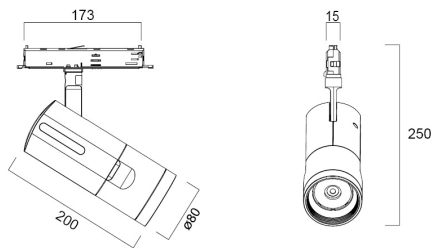

### Fotometrie

| Distance [m] | Cone diameter [m] | Beam diameter [m] | Beam diameter [m] | Illuminance [lx]     |
|--------------|-------------------|-------------------|-------------------|----------------------|
| 0.5          | 0.17<br>0.17      | 0.07              | 0.07              | 4248<br>2071<br>2152 |
| 1.0          | 0.34<br>0.33      | 0.14              | 0.14              | 1062<br>518<br>535   |
| 1.5          | 0.51<br>0.50      | 0.21              | 0.21              | 457<br>230<br>236    |
| 2.0          | 0.68<br>0.67      | 0.28              | 0.28              | 270<br>131<br>133    |
| 2.5          | 0.85<br>0.84      | 0.35              | 0.35              | 173<br>85<br>86      |
| 3.0          | 1.01<br>1.00      | 0.42              | 0.42              | 127<br>63<br>64      |

Distance [m] Cone diameter [m] Beam diameter [m] Illuminance [lx]  
 — C0 - C180 (Half beam angle: 19.0°)  
 — C90 - C270 (Half beam angle: 19.2°)

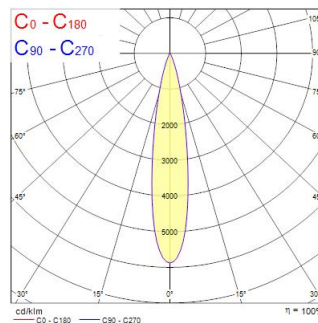

# Beacon CRI97 18W 1850lm 3000K Smal SSC Wit

Artikelnummer 2062488

Concord

## Algemene gegevens

|                                   |  |
|-----------------------------------|--|
| Productnaam                       | Beacon CRI97 18W<br>1850lm 3000K Smal SSC<br>Wit |
| Technologie                       | LED  |
| Lampvoet                          | N/A  |
| Behuizing                         | Aluminium  |
| Montage                           | Railmontage                                      |
| Geïntegreerde aanwezigheidssensor | NONE   |
| Type armatuur (open/gesloten)     | Ingesloten                                       |
| Algemene toepassing               | Museums en galerieën,<br>Winkel, Horeca          |
| Omgevingstemperatuur (°C)         | -10°C...+35°C                                    |
| Virtual assistant compatibility   | N/A  |
| ETIM klasse                       | EC001744   |
| Garantie                          | 5 jaar   |

## Optische gegevens

|                               |             |
|-------------------------------|-------------|
| Lumenstroom armatuur (lm)     | 1850        |
| Efficiëntie armatuur lm/W     | 103         |
| LOR (%)                       | 100         |
| Kleurtemperatuur (K)          | 3000        |
| Lichtkleur                    | Warmwit     |
| CRI (Ra)                      | 97          |
| Initiële kleurvariatie (SDCM) | SDCM2       |
| Luminous Intensity (cd)       | 1850        |
| Bundel breedte (°)            | 19          |
| Type licht distributie        | Symmetrisch |
| Fotobiologische risicogroep   | RG1         |

## Elektrische gegevens

|   |                             |
|---|-----------------------------|
| Nood type   |                             |
| Totaal energieverbruik (W)  | 18                          |
| Stroom (A)  | 0.082                       |
| Primaire voedingsspanning min   | 220.0                       |
| Primaire voedingsspanning max   | 240.0                       |
| Lamp arbeidsfactor  | 0.9                         |
| THD (bij 230 V, 50 Hz, volledige belasting, bij 100% dimniveau) $\leq$ xx.x % | 8.2                         |
| Elektrische beschermingsklasse  | Klasse II                   |
| Type ballast  | LED constante stroom driver |
| Dimbaar   | Ja                          |
| Dimtechnologie  | SylSmart Standalone (SSC)   |
| Minimum dimniveau (%)   | 1                           |
| Stuurstroom driver (mA)   | 500                         |
| Inschakelstroom (A)   | 20                          |
| Duur inschakelstroom ( $\mu$ s)   | 25                          |
| Energie-efficiëntieklasse (A->G) van de lichtbron in dit product              | F                           |
| Nominale frequentie (Hz)  | 50/60Hz                     |
| Max. Armaturen per 10A C automaat   | 50                          |
| Max. Armaturen per 13A C automaat   | 104                         |
| Max. Armaturen per 16A C automaat   | 136                         |
| Max. Armaturen per 20A C automaat   | 166                         |
| Max. Armaturen per 10A B automaat   | 50                          |
| Max. Armaturen per 13A B automaat   | 62                          |
| Max. Armaturen per 16A B automaat   | 80                          |
| Max. Armaturen per 20A B automaat   | 100                         |

## Gegevens levensduur

|  |        |
|--|--------|
| Gemiddelde nominale levensduur - L70 B50 | 100000 |
| Gemiddelde nominale levensduur - L80 B50 | 100000 |
| Gemiddelde nominale levensduur - L90 B50 | 56000  |

# Beacon CRI97 18W 1850lm 3000K Smal SSC Wit

Artikelnummer 2062488

Concord

## Fysieke gegevens

|                     |                                  |
|---------------------|----------------------------------|
| Kleur behuizing     | RAL 9016 - Traffic white / Bezel |
| IP waarde           | IP20                             |
| IK waarde           | IK02                             |
| Afwerking diffusor  | Overige                          |
| Materiaal diffusor  | PMMA Acryl                       |
| Afwerking reflector | Not Applicable                   |
| Lengte (mm)         | 200                              |
| Breedte (mm)        | 80                               |
| Hoogte (mm)         | 250                              |
| Gewicht (kg)        | 1.2                              |

## Verpakkingen

|                                |                |
|--------------------------------|----------------|
| EAN code                       | 5025768624881  |
| Enkele lengte verpakking (cm)  | 30.5           |
| Enkele breedte verpakking (cm) | 13.5           |
| Hoogte eenheidsverpakking (cm) | 20.5           |
| DUN14 (inner)                  | 05025768624881 |
| Eenheden per omdoos            | 1              |
| Lengte omdoos (cm)             | 30.5           |
| Breedte omdoos (cm)            | 13.5           |
| Diepte omdoos (cm)             | 20.5           |

## Veiligheidsgegevens

|  |        |
|--|--------|
| Gloeidraad test (°)                            | 650    |
| Optimale bedrijfsomstandigheden (°C)           | -10-35 |
| Uitsluitend te gebruiken in droge toepassingen | Ja     |